

# SATSON<sup>®</sup> HDM-EXT-0106C

## HDMI extender over single cat.X

Transmitter



Receiver



### Connection Warranty

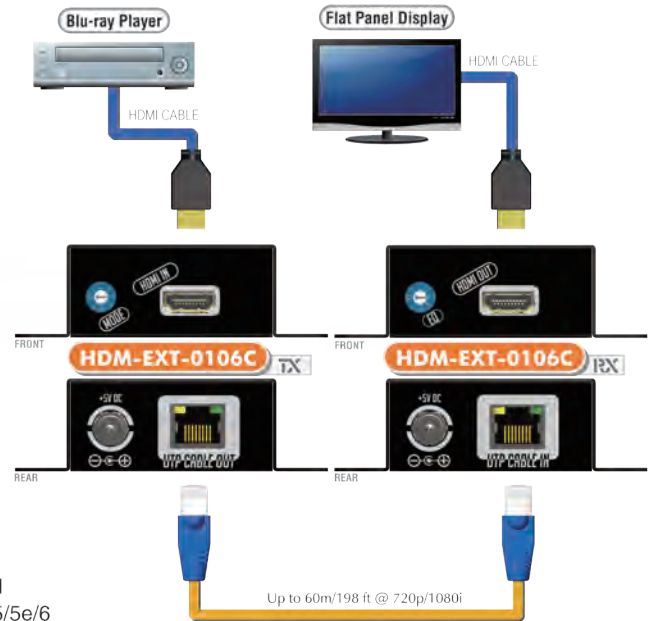

### Specifications

Model Name	HDM-EXT-0106C	
Technical	HDM-EXT-0106C [TX]	HDM-EXT-0106C [RX]
Role of usage	Transmitter [Tx]	Receiver [Rx]
HDMI compliance	HDMI Deep Color & full 3D	
HDCP compliance	Yes	
Video bandwidth	Single-link 225MHz [6.75Gbps]	
Video support	480i / 480p / 720p / 1080i / 1080p60 up to 36-bit color	
HDMI over UTP transmission [24-bit]	Full HD (1080p)-40m (130ft) [CAT5e] / 50m (165ft) [CAT6] HD (720p/1080i)-50m (165ft) [CAT5e] / 60m (200ft) [CAT6]	
Audio support	Surround sound [up to 7.1ch] or stereo digital audio	
Equalization	8-level digital control at RX	
Input TMDS signal	1.2 Volts [peak-to-peak]	
Input DDC signal	5 Volts [peak-to-peak, TTL]	
ESD protection	[1] Human body model — ±19kV [air-gap discharge] & ±12kV [contact discharge] [2] Core chipset — ±8kV	
PCB stack-up	4-layer board [impedance control — differential 100Ω; single 50Ω]	
Input	1x HDMI	1x RJ-45
Output	1x RJ-45	1x HDMI
HDMI connector	Type A [19-pin female]	
RJ-45 connector	WE/SS 8P8C with 2 LED indicators	
Rotary switch	Mode	Signal level
<b>Mechanical</b>		
Housing	Metal enclosure	
Dimensions [L x W x H]	Model	[TX/RX] 91 x 60 x 26mm [3.6" x 2.4" x 1"]
	Package	270 x 175 x 80mm [10.6" x 6.9" x 3.1"]
	Carton	450 x 370 x 300mm [17.7" x 14.6" x 11.8"]
Weight	Model	200g [7 oz]      196g [6.9 oz]
	Package	900g [2 lbs]
Fixedness	Wall-mounting case with screws	
Power supply	5V 2A DC	
Power consumption	4 Watt [max]	1.5 Watt [max]
Operation temperature	0~40°C [32~104°F]	
Storage temperature	-20~60°C [-4~140°F]	
Relative humidity	20~90% RH [no condensation]	

### Features

- Support HDMI Deep Color & full 3D
- Extends the transmission up to 60m (200ft) from the HDMI source at HD 1080i or 720p 24-bit color
- Extends the transmission up to 40m (130ft) from the HDMI source at Full HD 1080p 24-bit color
- Extends the transmission length up to 20m (65ft) from the HDMI sources under Full HD resolution(1080p at 36-bit color depth)
- HDCP 1.1 compliant
- Minimizes the cable skew by adjustable 8-level equalization control
- Pure unaltered uncompressed 7.1ch digital HDMI over Cat.5/5e/6 cable transmission
- DTS-HD and Dolby TrueHD high bit rate audio support
- Allows cascading
- Wall mounting housing design for easy and robust installation
- Perfectly integrated with other HDMI over CAT5 series products

### Package Contents

- 1x HDM-EXT-0106C [TX & RX]
- 2x DC 5V 2A wall wart
- 1x User manual