

SATSON®

User Manual

HDM-EXT-0107C

**HDMI Extender over Single Cat.X with
HDBasedT, RS-232, Bi-directional IR,
Ethernet & POE**



HDCP™
HIGH-DEFINITION CONTENT PROTECTION

WUXGA
x1920
x1200

Full HD
1080

CE

FCC

RoHS
Compliance

7.1 CH
AUDIO

Blu-ray
3D
READY

x.v.Color

dts-HD
High Resolution Audio

DOLBY
TRUEHD

CAT.5e/6/7
SINGLE
PATENTED

rev: 121219
Made in Taiwan



Safety and Notice

The **HDM-EXT-0107C HDMI Extender over Single Cat.X with HDBasedT, RS-232, Bi-directional IR, Ethernet & POE** has been tested for conformance to safety regulations and requirements, and has been certified for international use. However, like all electronic equipments, the **HDM-EXT-0107C** should be used with care. Please read and follow the safety instructions to protect yourself from possible injury and to minimize the risk of damage to the unit.

- Follow all instructions and warnings marked on this unit.
- Do not attempt to service this unit yourself, except where explained in this manual.
- Provide proper ventilation and air circulation and do not use near water.
- Keep objects that might damage the device and assure that the placement of this unit is on a stable surface.
- Use only the power adapter and power cords and connection cables designed for this unit.
- Do not use liquid or aerosol cleaners to clean this unit. Always unplug the power to the device before cleaning.

TABLE OF CONTENTS

● INTRODUCTION	1
● FEATURES	1
● SPECIFICATIONS	2
● PACKAGE CONTENTS	3
● PANEL DESCRIPTIONS	4
Transmitting unit ► HDM-EXT-0107C [Tx]	4
Receiving unit ► HDM-EXT-0107C [Rx]	5
● IR PASS-THROUGH	6
● HARDWARE INSTALLATION	7
● EDID LEARNING	7
● PIN DEFINITION	8
● NOTICE	9
● PERFORMANCE GUIDE	9

INTRODUCTION

The **HDM-EXT-0107C HDMI Extender over Single Cat.X with HDBasedT, RS-232, Bi-directional IR, Ethernet & POE** boosts up your video/audio transmission distance up to m (ft) in HDTV 1080p with 48-bit color depth. HDM-EXT-0107C also supports the most advanced 3D video format complaint with HDMI specification and therefore guarantees the highest 3D video compatibility on the market. With only one cost effective Cat.5/5e/6 cable, users can readily extend HDTV sources from DVD players, Blu-ray Disc player, PS3, PC, and any other kinds of sources compliant with TMDS to distant display monitors including HDMI or DVI enabled TV sets or LCD PC monitors. With the advanced design for the latest HDMI technology, deep color video, DTS-HD or Dolby TrueHD audio, and HDCP supports and compatibility are all further insured. This flexibility makes HDCP compliant DVD players or PS3 transmit utmost high quality video and audio with a greater distance at the minimal cost, when integrating several components apart. In addition, HDM-EXT-0107C is also equipped with bi-directional IR pass-through path and RS-232 serial port control. These bonus features allow users to boost IR control distance up to 100m (330 ft) and makes IR control possible through only single Cat.5/5e/6 cable including HDMI signals. In addition, serial port offers the convenient path for interactive application, such as touch panels. In addition, HDM-EXT-0107C also supports POE (Power over Cable) which can power both units from TX or RX with power supply.

The HDM-EXT-0107C includes two units: transmitting unit HDM-EXT-0107C-TX and receiving unit HDM-EXT-0107C-RX. The transmitting unit is used to capture the input HDMI / DVI signals with IR control packets and carry the signals via one cost effective Cat.5/5e/6 cable. The receiving unit is responsible for equalizing the transmitted HDMI signal and reconstructing IR and serial control signals. HDM-EXT-0107C offers the most convenient solution for digital signage with long distance A/V transmission path, and with 10G transmission width ready, HDM-EXT-0107C is ready for your next HDMI generation and applications!

FEATURES

- Support HDMI Deep Color, full 3D & 4K2K@30 (HDBaseT technology)
- Extend the transmission up to 100m (330ft) from the HDMI source at Full HD 1080p 48-bit
- Support POE(Power over Cable) which can power both units from TX or RX with power supply.
- HDCP & EDID Bypass
- CEC support
- Auto equalization
- Pure unaltered uncompressed 7.1ch digital HDMI over Cat.5/5e/6 cable transmission
- DTS-HD Master Audio and Dolby TrueHD high bit rate audio support
- Support full frequency IR signal from 20KHz to 60KHz
- Bi-directional IR path-through
- Full Duplex RS-232 control up to 115,200 bps through connector
- Integrated Ethernet port for LAN/ network device
- Wall mounting housing design for easy and robust installation

i

The length depends on the characteristics and quality of the cables. Higher resolutions and longer transmission distances require low skew cables (<25ns/100m) for best performance. Unshielded CAT6 with metal RJ-45 connectors is recommended.

SPECIFICATIONS

Model Name		HDM-EXT-0107C	
Technical		HDM-EXT-0107C [Tx]	HDM-EXT-0107C [Rx]
Role of usage		Transmitter [TX]	Receiver [RX]
HDMI compliance		HDMI Deep Color, full 3D & 4K2K@30	
HDCP compliance		Yes	
Video bandwidth		Single-link 340MHz [10.2 Gbps]	
Video support		480i / 480p / 720p / 1080i / 1080p60	
HDMI over UTP		1080p@60 100m (330ft) [CAT5e]	
Audio support		Surround sound [up to 7.1ch] or stereo digital audio	
Equalization		Auto	
Input TMDS signal		1.2 Volts [peak-to-peak]	
Input DDC signal		5 Volts [peak-to-peak, TTL]	
ESD protection		[1] Human body model — ±19kV [air-gap discharge] & ±12kV [contact discharge] [2] Core chipset — ±8kV	
PCB stack-up		6-layer board [impedance control — differential 100Ω; single 50Ω]	
IR pass-thru		Bi-directional	
RS-232 support		Yes	
Ethernet support		Yes	
POE support		Yes	
Input		1x HDMI / 1x 3.5mm	1x RJ-45(Video) / 1x 3.5mm
Output		1x RJ-45(Video) / 1x 3.5mm	1x HDMI / 1x 3.5mm
In / Out		1x DIN9 / 1x RJ-45(Ethernet)	1x DIN9 / 1x RJ-45(Ethernet)
HDMI source control		Controllable via IR pass-through from RX to TX with IR extenders	
IR remote control		Type A [19-pin female]	
HDMI connector		DIN-9	
RJ-45 connector		WE/SS 8P8C(Reverse Mode)	
Rotary control switch		None	
3.5mm connector		IR receiver / IR blaster	IR receiver / IR blaster
Mechanical			
Housing		Metal enclosure	
Dimensions [L x W x H]	Model	85 x 60 x 25mm [3.3" x 2.4" x 1"]	
	Package	270 x 175 x 80mm [10.6" x 6.9" x 3.1"]	
	Carton	450 x 370 x 300mm [1'6" x 1'3" x 11.8"]	
Weight	Model	320g [11 oz]	
	Package	720g [1.6 lbs]	
Fixedness		Wall-mounting case with screws	
Power supply		24V1A	
Power consumption		Max 12W	
Operation temperature		0~40°C [32~104°F]	
Storage temperature		-20~60°C [-4~140°F]	
Relative humidity		20~90% RH [no condensation]	

PACKAGE CONTENTS

- 1x HDM-EXT-0107C [TX & RX]
- 1x IR blaster
- 1x IR receiver
- 1x DC 24V in-line with C7 power cord
- 1x User manual

CONNECTION WARRANTY

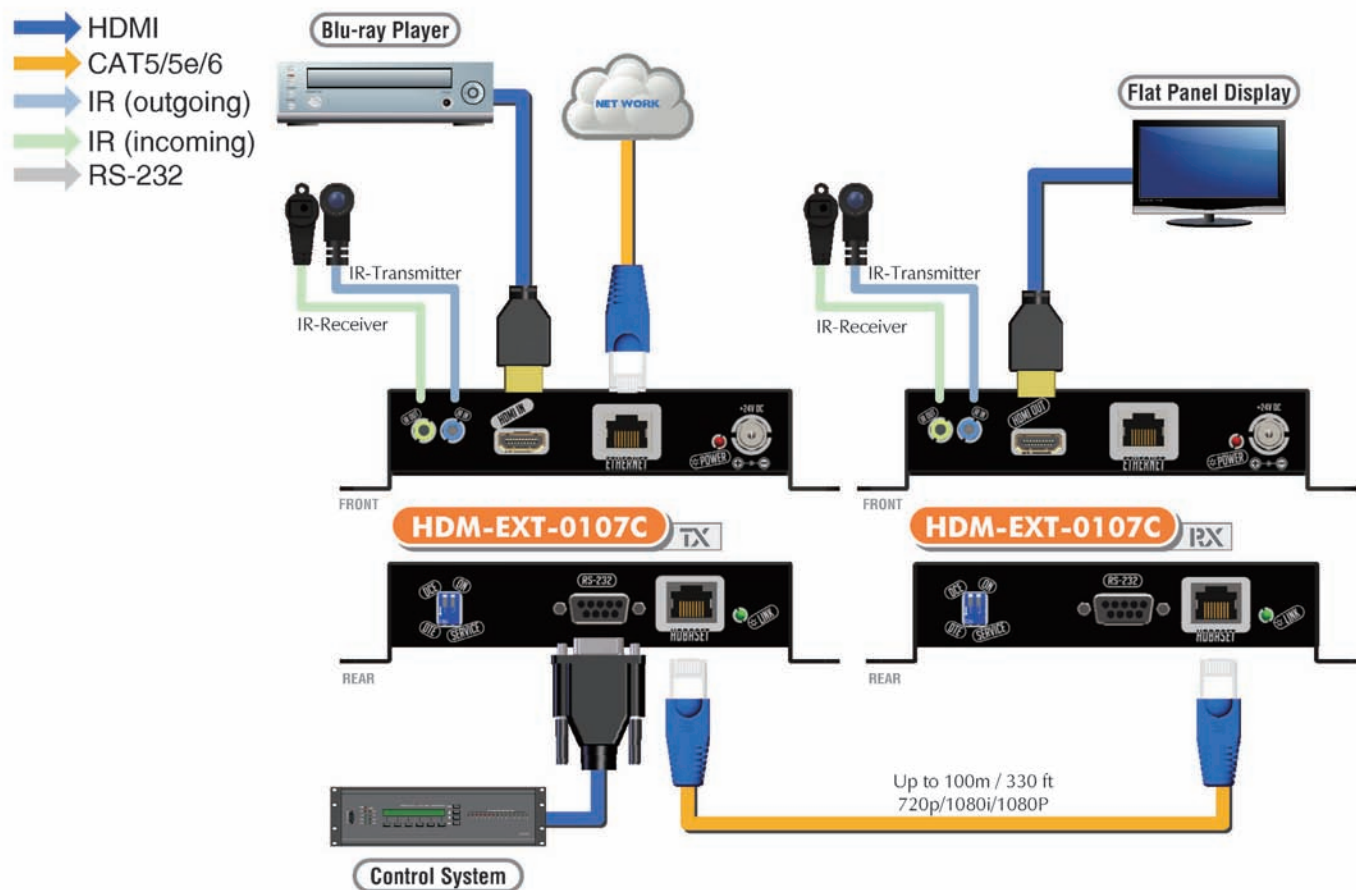

PANEL DESCRIPTIONS

Transmitting unit ► HDM-EXT-0107C [Tx]

Input Panel

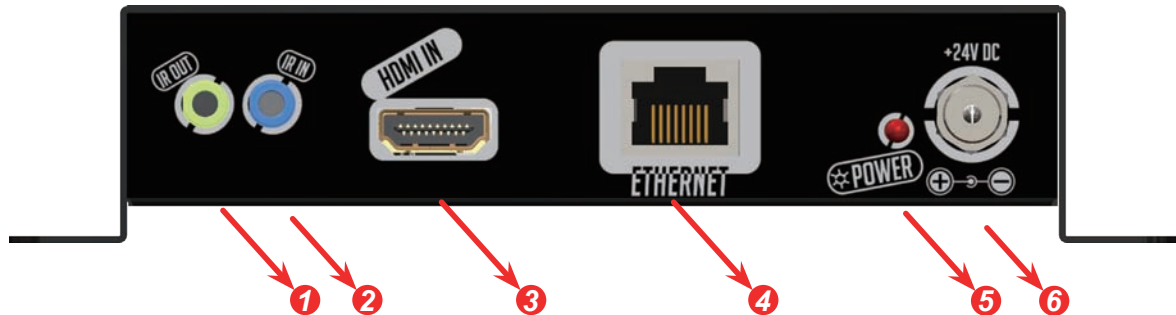

- ❶ **IR Blaster:** Infrared 3.5mm socket for plugging in the extension cable of IR blaster
- ❷ **IR Receiver:** Infrared 3.5mm socket for plugging in the extension cable of IR receiver
- ❸ **HDMI IN:** Connects to a HDMI source with a HDMI male-male cable
- ❹ **Ethernet**
- ❺ **LED:** Power indicator
- ❻ **+24V DC:** Connect to a 24V DC power supply.

Output Panel

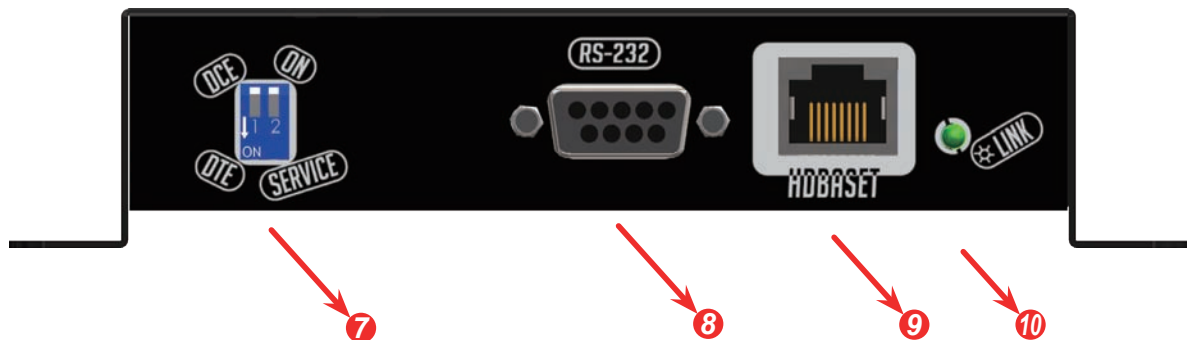

- ❷ **DIP Switch:** PIN#1: Setup the RS-232 mode for serial communication channel.
PIN#2: For Firmware Update
- ❸ **RS-232:** Connect to serial port device with a DSUB-9 male-male or male-female cable here
- ❹ **RJ45:** Plug in a Cat-5/5e/6 cable that needs to be linked to the transmitting unit HDM-EXT-0107C-RX.
- ❺ **LED:** TX/RX link indicator

Receiving unit ► HDM-EXT-0107C [Rx]

Input Panel

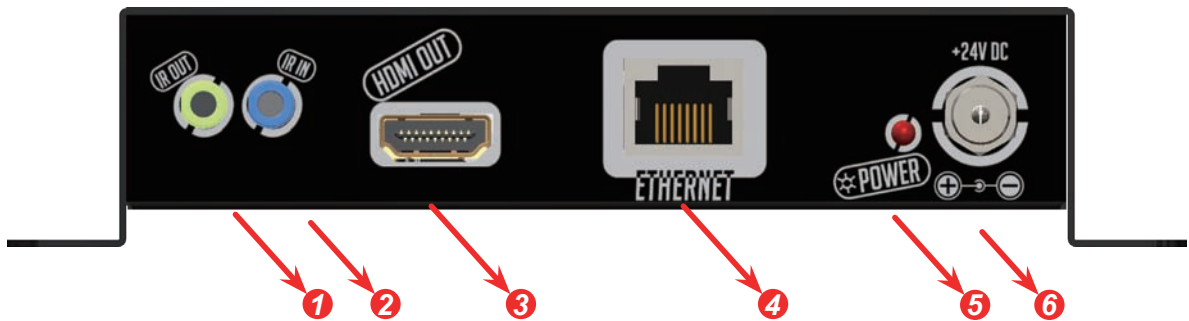

- 1 **IR Blaster:** Infrared 3.5mm socket for plugging in the extension cable of IR blaster
- 2 **IR Receiver:** Infrared 3.5mm socket for plugging in the extension cable of IR receiver
- 3 **HDMI OUT:** Connect to a HDMI display with a HDMI male-male cable
- 4 **Ethernet**
- 5 **LED:** Power indicator
- 6 **+24V DC:** Connect to a 24V DC power supply.

Output Panel



- 7 **DIP Switch:** PIN#1: Setup the RS-232 mode for serial communication channel.
PIN#2: For Firmware Update
- 8 **RS-232:** Connect to serial port device with a DSUB-9 male-male or male-female cable here
- 9 **RJ45:** Plug in a Cat-5/5e/6 cable that needs to be linked to the transmitting unit HDM-EXT-0107C-RX.
- 10 **LED:** TX/RX link indicator

DIP Switch Position		Description
TX & RX		
Solid	ON[↓]	TxD: The 2 nd pin of RS-232, which is in charge of sending data RxD: The 3 rd pin of RS-232, which is in charge of receiving data
	OFF [↑]	TxD: The 3 rd pin of RS-232, which is in charge of sending data RxD: The 2 nd pin of RS-232, which is in charge of receiving data
Stranded	ON[↓]	Firmware Update
	OFF [↑]	Normal

IR PASS-THROUGH

IR Extenders

IR Blaster



IR Receiver



IR Sockets

IR BLASTER: plug in the IR blaster to emit all IR command signals received from the IR receiver from the other end to control the devices corresponding to the IR signals.

IR RECEIVER: plug in the IR receiver to receive all IR command signals from the IR remote controls of the corresponding devices.



CAUTION!

Incorrect placement of IR Blaster and Receiver may result in the failure of the IR extenders. Please check carefully before plugging in the IR extender to the respective IR sockets. Warranty will not cover the damage.

Definition of IR Earphone Jack

IR Blaster



IR Receiver

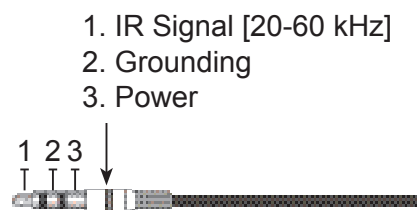

i

You can buy any IR extension cables in the market that are compatible to the definition of the IR sockets for the matrix if necessary for replacement use. However, IR cables longer than 2m (6-ft) may not work.

HARDWARE INSTALLATION

1. Connect a HDMI or DVI source (such as a Blu-ray Disc player) to the transmitting unit of HDM-EXT-0107C.
2. Connect a HDMI or DVI display (such as a LCD TV) to the receiving unit HDM-EXT-0107C-RX.
3. Connect IR Blaster/Receiver to both TX and RX units.
4. Connect USB cable to PC/Laptop
5. Connect a Cat-5/5e/6 cable between the transmitting and receiving units.
6. Make sure this Cat-5/5e/6 cable is tightly connected and not loose.
7. Plug in 24V DC power supply unit to the power jack of the transmitting unit HDM-EXT-0107C-TX.

PIN DEFINITION

HDMI

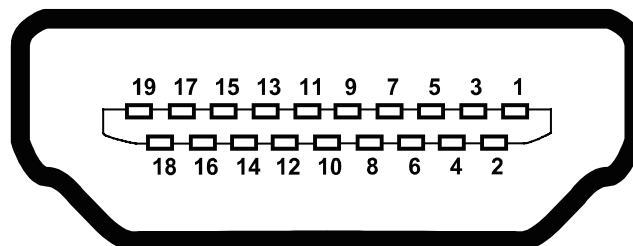

Type A (Receptacle) HDMI

Pin 1	TMDS Data2+	Pin 8	TMDS Data0 Shield	Pin 15	SCL
Pin 2	TMDS Data2 Shield	Pin 9	TMDS Data0–	Pin 16	SDA
Pin 3	TMDS Data2–	Pin 10	TMDS Clock+	Pin 17	DDC/CEC Ground
Pin 4	TMDS Data1+	Pin 11	TMDS Clock Shield	Pin 18	+5V Power
Pin 5	TMDS Data1 Shield	Pin 12	TMDS Clock–	Pin 19	Hot Plug Detect
Pin 6	TMDS Data1–	Pin 13	CEC		
Pin 7	TMDS Data0+	Pin 14	Reserved (N.C. on device)		

NOTICE

1. All HDMI over CAT5 transmission distances are measured using Belden 1583A CAT5e 125MHz UTP cable and ASTRODESIGN Video Signal Generator VG-859C & VG-870B.
2. Incorrect placement of IR Blaster and Receiver may result in the failure of the IR extenders. Please check carefully before plugging in the IR extender to the respective IR sockets. Warranty will not cover the damage.
3. The transmission length is largely affected by the type of Cat-5/5e/6 cables, the type of HDMI sources, and the type of HDMI display. The testing result shows solid UTP cables (usually in the form of 300m [1,000ft] bulk cables) can transmit a lot longer signals than stranded UTP cables (usually in the form of fixed length patch cords). Shielded STP cables are better suited than unshielded UTP cables. A solid UTP Cat-5e cable shows longer transmission range than stranded STP Cat-6 cable. For long extension applications, solid UTP/STP cables are the only viable choice.
4. EIA/TIA-568-B termination (T568B) for Cat-5/5e/6 cables is recommended for better performance.
5. To reduce the interference among the unshielded twisted pairs of wires in Cat-5/5e/6 cable, one can use shielded STP cables to improve EMI problems, which is worsen in long transmission.
6. Because the quality of the CAT5/6 cables has the major effect on how long the transmission limit can achieve and how good is the received picture quality, the actual transmission range is subject to one's choice of Cat-5/5e/6 cables. For desired resolutions greater than 1080i or 1280x1024, a Cat-6 cable is recommended.
7. If your HDMI display has multiple HDMI inputs, it is found that the first HDMI input [HDMI input #1] generally can produce better transmission performance among all HDMI inputs.

Performance rating		Type of category cable		
Wiring	Shielding	CAT5	CAT5e	CAT6
Solid	Unshielded (UTP)	★★★	★★★★★	★★★★★
	Shielded (STP)	★★★	★★★	★★★★★
Stranded	Unshielded (UTP)	★	★★	★★
	Shielded (STP)	★	★	★★
Termination		Please use EIA/TIA-568-B termination (T568B) at any time		

WARRANTY

The SELLER warrants the **HDM-EXT-0107C HDMI Extender over Single Cat.X with HDBasedT** free from defects in the material and workmanship for 1 year from the date of purchase from the SELLER or an authorized dealer. Should this product fail to be in good working order within 1 year warranty period, The SELLER, at its option, repair or replace the unit, provided that the unit has not been subjected to accident, disaster, abuse or any unauthorized modifications including static discharge and power surge. This warranty is offered by the SELLER for its BUYER with direct transaction only. This warranty is void if the warranty seal on the metal housing is broken.

Unit that fails under conditions other than those covered will be repaired at the current price of parts and labor in effect at the time of repair. Such repairs are warranted for 90 days from the day of reshipment to the BUYER. If the unit is delivered by mail, customers agree to insure the unit or assume the risk of loss or damage in transit. Under no circumstances will a unit be accepted without a return authorization number.

The warranty is in lieu of all other warranties expressed or implied, including without limitations, any other implied warranty or fitness or merchantability for any particular purpose, all of which are expressly disclaimed.

Proof of sale may be required in order to claim warranty. Customers outside Taiwan are responsible for shipping charges to and from the SELLER. Cables and power adapters are limited to a 30 day warranty and must be free from any markings, scratches, and neatly coiled. The content of this manual has been carefully checked and is believed to be accurate. However, The SELLER assumes no responsibility for any inaccuracies that may be contained in this manual. The SELLER will NOT be liable for direct, indirect, incidental, special, or consequential damages resulting from any defect or omission in this manual, even if advised of the possibility of such damages. Also, the technical information contained herein regarding the **HDM-EXT-0107C** features and specifications is subject to change without further notice.

saison®